

# eWind-ventilation units

Installing an external RH- or CO<sub>2</sub>-sensor to eWind-automation

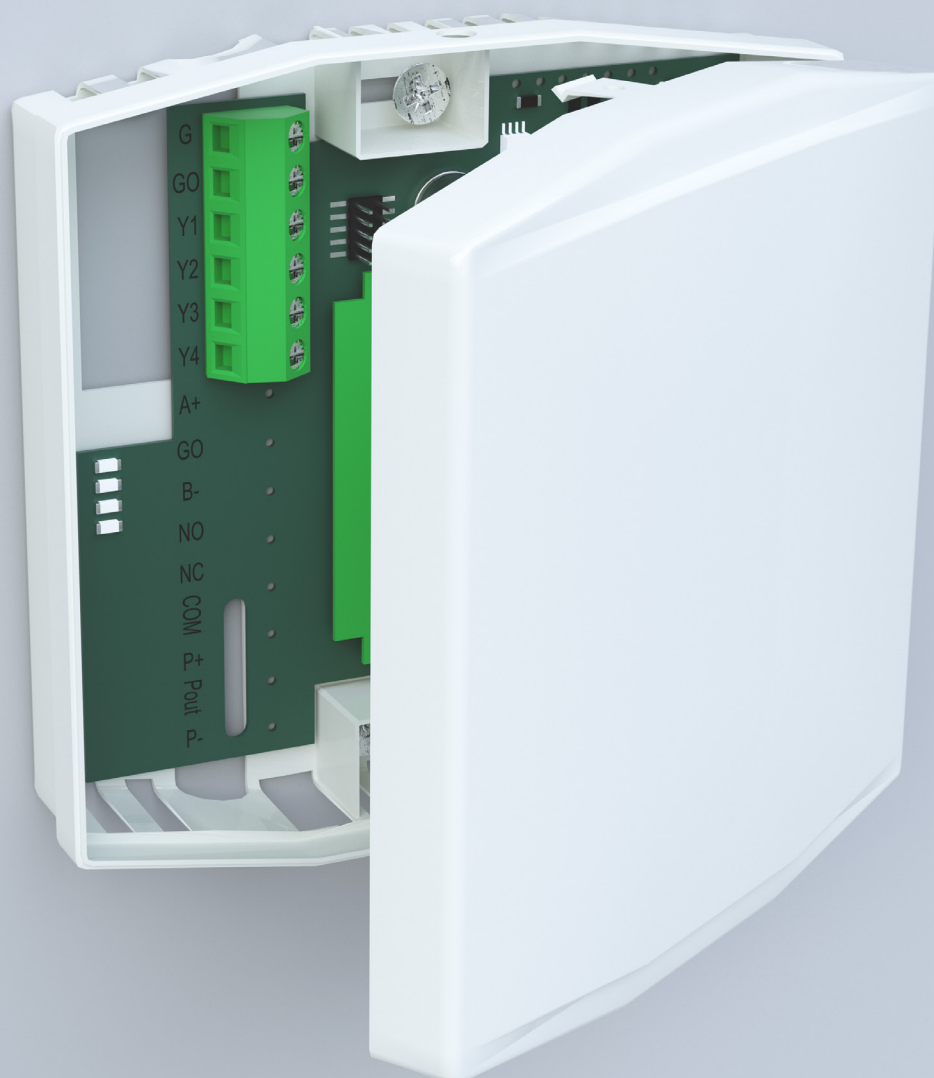

***enervent***

# SAFETY

---

## General

### DANGER

Always check that the equipment supply voltage is switched off before opening the service hatch.

### WARNING

In case of malfunction, always find out the reason for the malfunction before starting the unit again.

### WARNING

Wait for two (2) minutes after switching off the power of the unit before commencing the maintenance. Although the power is switched off, the fans continue running and the heating element stays hot for a while.

## Electrical safety

### DANGER

Only an authorised electrician may perform any actions in the electrical box.

### DANGER

Follow the local regulations on electrical installations.

### CAUTION

Check that the unit is entirely isolated from the mains before conducting any voltage tests, insulation resistance measurements or other electrical work or measurements. Such work may damage the sensitive electrical devices.

### CAUTION

Control devices used in the ventilation units may cause leakage current. It may affect the operation of the residual current devices.

### CAUTION

All ventilation units with a control system must be equipped with an over-voltage arrester.

# INSTALLING EXTERNAL SENSORS

The eWind- automation is already at the factory pre-programmed for an external humidity (RH) -sensor. If the external sensor is a humidity sensor, changes to the sensor parameters are not required. If the external sensor is a CO<sub>2</sub>-sensor, the changes to sensor parameters shown on the next page must be done from the eWind operating panel.

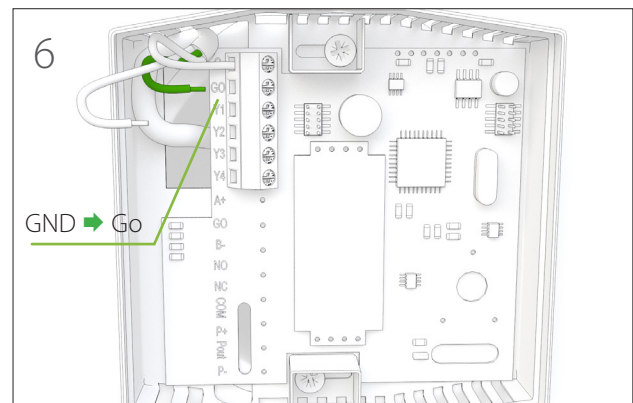
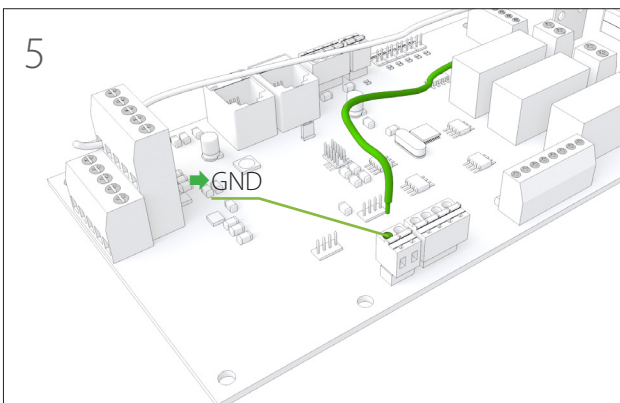
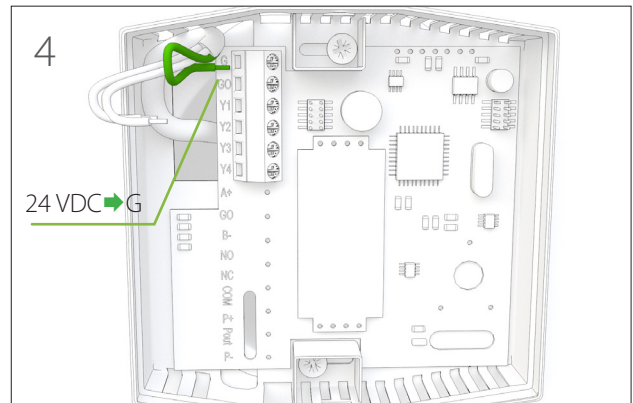
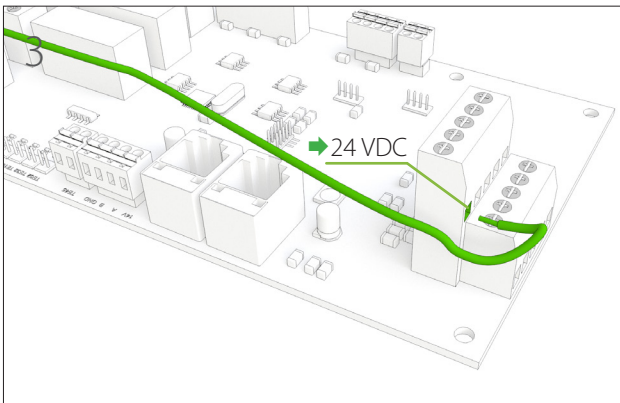
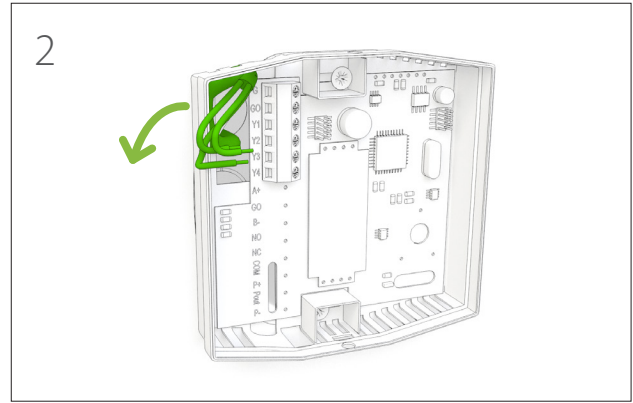
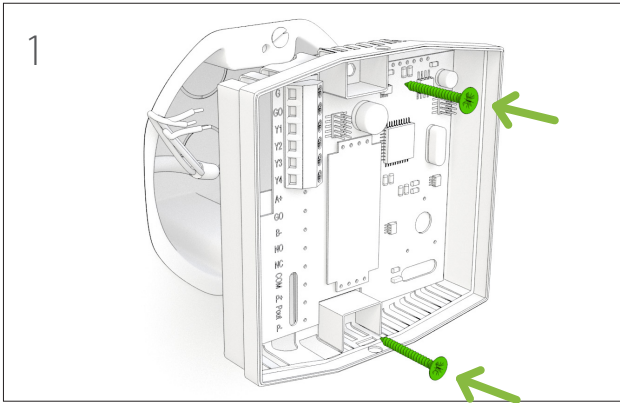

## DANGER

Only an authorised electrician may perform electrical work in ventilation units.

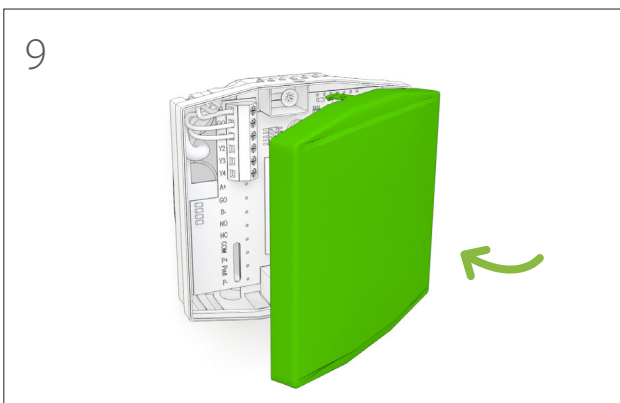
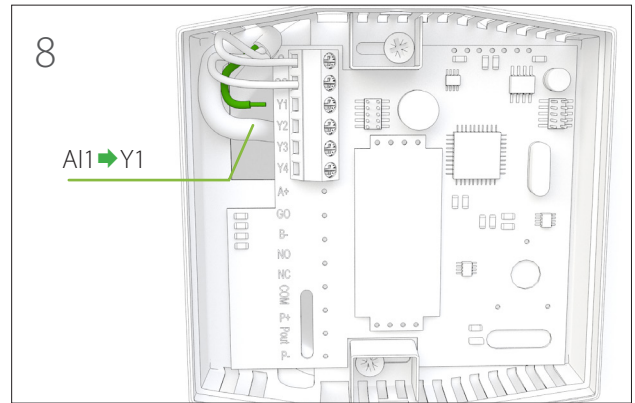





### Setting of the control system sensor parameter for CO<sub>2</sub>-sensor

- 1 Simultaneously press buttons  and  three times in the control panel.



---

- 2 Using buttons  and , choose parameter c27.

---

- 3 Choose the parameter for adjustment by pressing button  for 3 seconds.



---

- 4 Change the parameter value to ON using buttons  and .

---

- 5 Confirm the value by pressing button .

---

- 6 Exit the settings by simultaneously pressing buttons  and .



# Electrical diagram

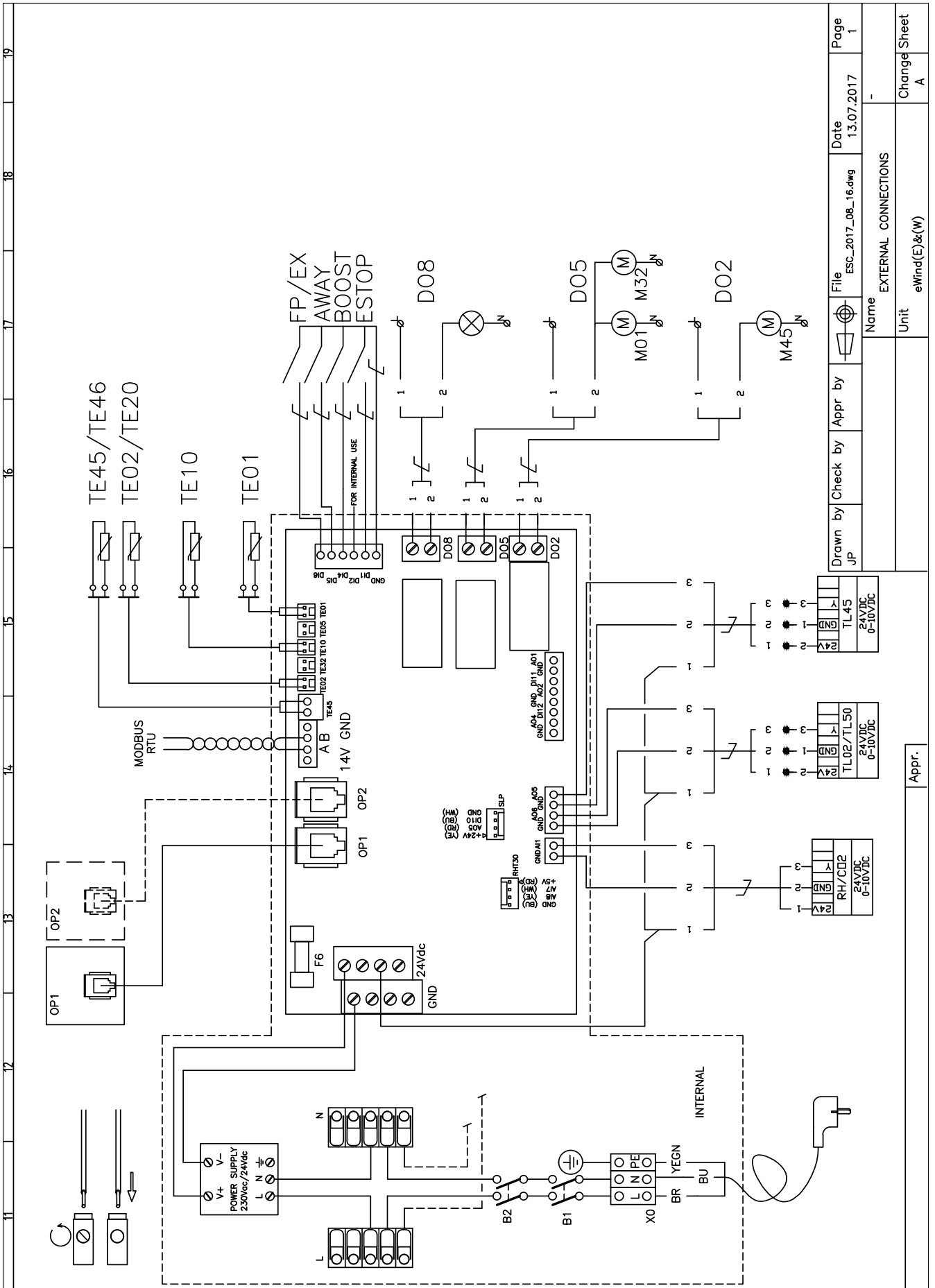

11 12 13 14 15 16 17 18 19

Drawn by	JP	Check by		Appr by		File	Esc_2017_08_16.dwg	Date	13.07.2017	Page	1
Name							EXTERNAL CONNECTIONS			Change Sheet	
Unit							eWind(E)&(W)			A	

Appr.



Enervent Oy  
Kipinätie 1  
FIN-06150 Porvoo, Finland  
Tel. +358 207 528 800  
Fax. +358 207 528 844  
enervent@enervent.com  
**www.enervent.com**