

Commissioning

WiFi module & iSLa app

The Enervent iSLa app allows you to control your Enervent air handling unit equipped with a WiFi module, directly from your phone.

You can control the unit locally without any internet access or remotely over the internet.



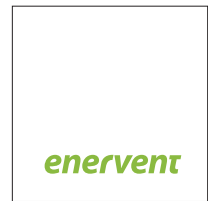

NOTE!

A software update (v.1.43 or newer) is required for air handling units with eAir automation with two displays connected.

Otherwise the WiFi module won't work properly.

A software update (v.1.43 or newer) is required for Svea Cooler units.

Otherwise the WiFi module won't work properly.

The software version can be checked in "system information" on the eAir display.

- Turn off the ventilation unit.
- Connect the WiFi module with the RJ11 cable (directly to one of the main board display ports (1), or between the display and the main board (2)).

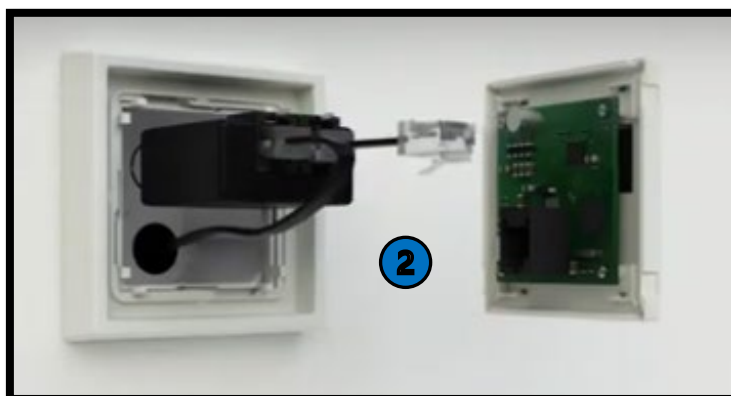
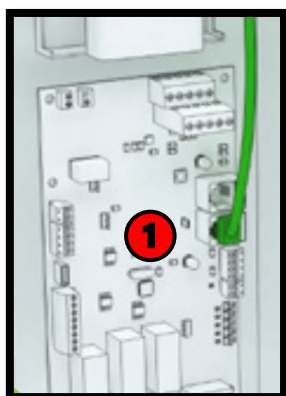

- Turn on the ventilation unit and wait for two minutes.
- Reset the WiFi module by placing the magnet (3) on top of the WiFi module (exactly as in the picture).
- Notice how the green led (4) is blinking on the WiFi module.



Old WiFi module (update is required):

- Two sec. ON / Two sec. OFF
- Immediately when the blinking stops (after 10 sec), remove the magnet.

New WiFi module (update is not required):

- Blinking very fast
- Immediately when the blinking stops (after 10 sec), remove the magnet.

The WiFi module is now reset.



Old WiFi module:

- Open the iSLa app.
- Register an account.
- Open the WiFi settings in the phone settings and select network "mist-ewind".
 - make sure the phone supports a 2,4Ghz WiFi network.
- Open the iSLa app.
- Select **NOT** (Android) **YES** (iOS) to use "mobile data" when asked.
- Select "Add another air handling unit".
- Select the WiFi module from the list in "Bluetooth units" (eWind xx).
If it doesn't show (or the upgrade won't start), select "WiFi-only units" in "Older firmware".
- Select "Start firmware upgrade".
- Stay on the page and wait until the counter shows 100%.
- Go one page backwards.
- Select the WiFi module from the list in "Bluetooth units".
If it doesn't show;
 - make sure Bluetooth is activated in the phone settings.
 - restart the ventilation unit and wait two minutes, now it should show.

New WiFi module:

- Open the iSLa app.
- Register an account.
- Select "Add another air handling unit".
- Select the WiFi module in "Bluetooth units".
If it doesn't show;
 - make sure Bluetooth is activated in the phone settings.
 - restart the ventilation unit and wait two minutes, now it should show.
(If not, go one step back and press "Add another air handling unit", now it should show.)



- Register the air handling unit.
- Input the unit serial number (can be found on the unit type plate)
 - **NOTE:** Not the number shown on the WiFi module when (if) asked
- Select whether to use the app locally or connecting to an external WiFi network (2.4Ghz).
- After installation, restart the iSLa app and the ventilation unit (if for some reason still doesn't work).
- Troubleshooting can be found at enervent.com/app

