

enervent



Enervent Salla

A SMALL BALL OF FIRE

Enervent Salla is a perfect ventilation unit for spaces that many other units can't fit into. Going short of size does not mean going short of features – Salla is proof that efficiency does not equal size.



SMALL UNIT, GREAT POWER

Larger exterior dimensions do not always mean a stronger device. Enervent Salla is a real ball of fire in a small casing. Go short of size - not quality.



FORGET DE-ROSTING

We found the point where freezing begins. This enabled us to design Enervent Salla's structure and airflows so that this unit doesn't freeze. When avoiding automatic defrosting, Enervent Salla can continually work energy efficiently. Salla is designed for Nordic conditions.



WHEN SPACE IS LIMITED

Enervent Salla is lower than most ventilation units and it has a built-in water lock for condense water. Due to these features, no installation space is required under the unit. It can i.e. be placed over a washing tower.



ENERGY EFFICIENT

Technical data

Air flow	50 - 374 m ³ /h	IP classification	IP44 (external control IP20)
Pressure diff.	15-125 Pa	External material	Steel sheet, zinc coated, powder painted.
Duct size	Ø 160 mm	Dimensions	580x500x490 mm
Duct size CHC	Ø 125 mm		
Connection for cooker hood	Ø 100 mm		
Weight	50 kg		

For complete technical information and technical drawings go to www.enervent.com/salla.

Salla is a small ventilation unit that is easy to place thanks to its compact size. It can be installed i.e. in the bathroom or in a closet. It is designed for single family houses and flats.

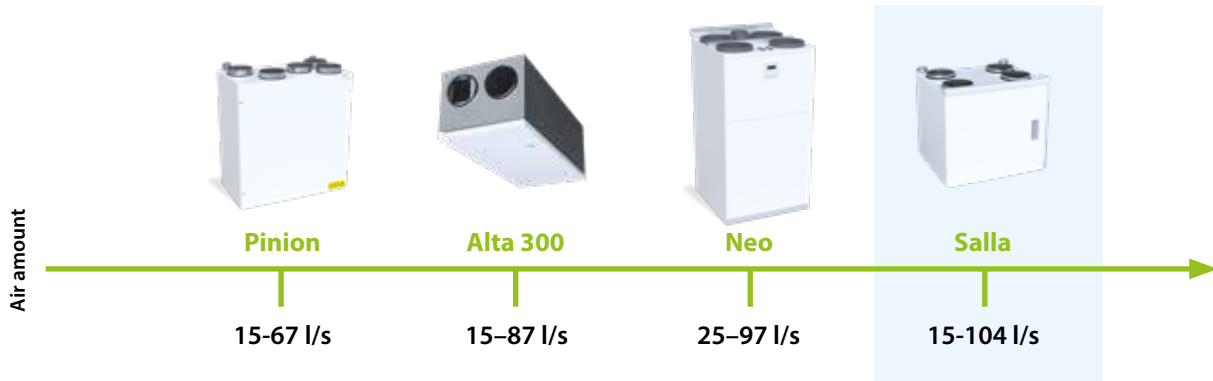

Case: Block of flats, Jyväskylä Finland

- Totally 120 apartments
- Apartment size 36–130 m²
- Ventilation unit: Enervent Salla

The ventilation unit can be installed in the bathroom or in a closet depending on the floor plan.

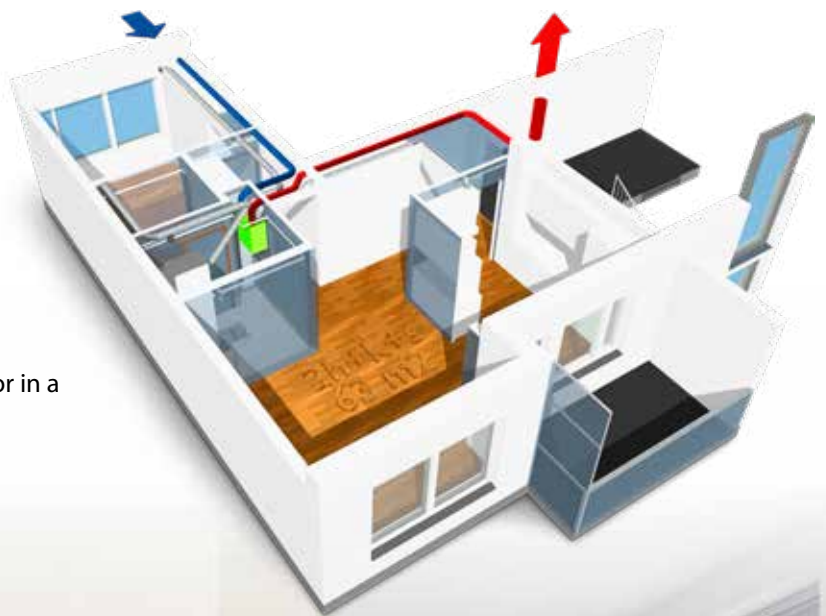

EASY CONTROL OVER EVERY SITUATION

Despite its versatile features, the control of Enervent Salla has been made easy for the user. Enervent eAir is a wireless control panel that controls your entire ventilation system. Control is based on easy usage situations, such as Home and Away.

The unit is also available with eWind control.



Enervent Zehnder Oy
Kipinätie 1
FI-06150 Porvoo, Finland
Tel: +358 207 528 800
enervent@enervent.com
www.enervent.com

enervent